



Right Plant, Right Place

Lynn Barber, Florida-Friendly Landscaping™ Agent

Jacqlyn Rivas, Microirrigation Program Coordinator

UF/IFAS Extension Hillsborough County

Florida-Friendly™ Landscaping

- What is it?
 - Integrated approach
 - Less time/\$
 - Wildlife friendly
- Goals
 - Conserve
 - Protect



Right Plant, Right Place

- 1st and foremost of 9 Florida-Friendly Landscaping™ principles
- Focus on water and environmental conservation
- Why?
 - Negative environmental impacts
 - FL current population 20 million residents
 - By 2060, 35 million residents projected
 - Water - not a renewable resource at the rate being used



Florida-Friendly™ Landscaping

Nine Principles

1. **Right plant, right place**
2. Water efficiently
3. Fertilize appropriately
4. Mulch
5. Attract wildlife
6. Manage yard pests
7. Recycle
8. Reduce stormwater runoff
9. Protect the waterfront



Right Plant, Right Place

- Plants selected for a specific site will require minimal amounts of water, fertilizer, pesticides and maintenance
- Thorough planning will help you place plants where their needs and yours are met



Are These Good Choices?



Right Plant, Right Place?



Tips and Examples

Narrow strips of grass - difficult to maintain



Tips and Examples



Tips and Examples

Before:



Tips and Examples

After:

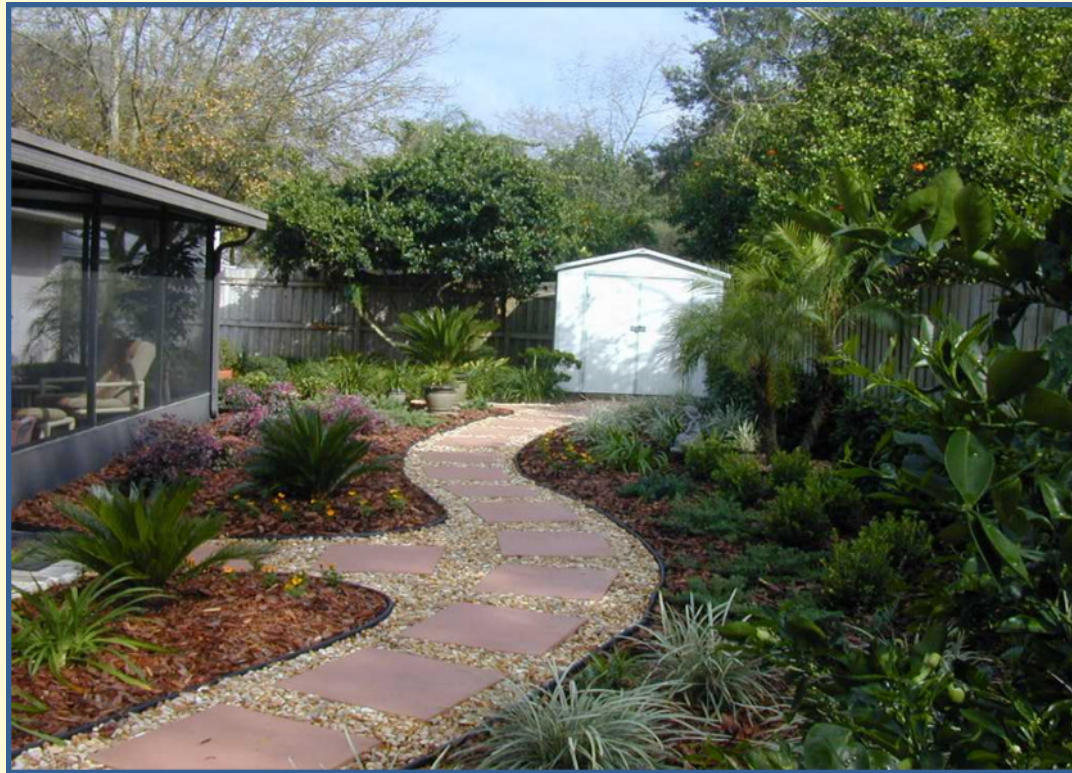

Tips and Examples

Before:

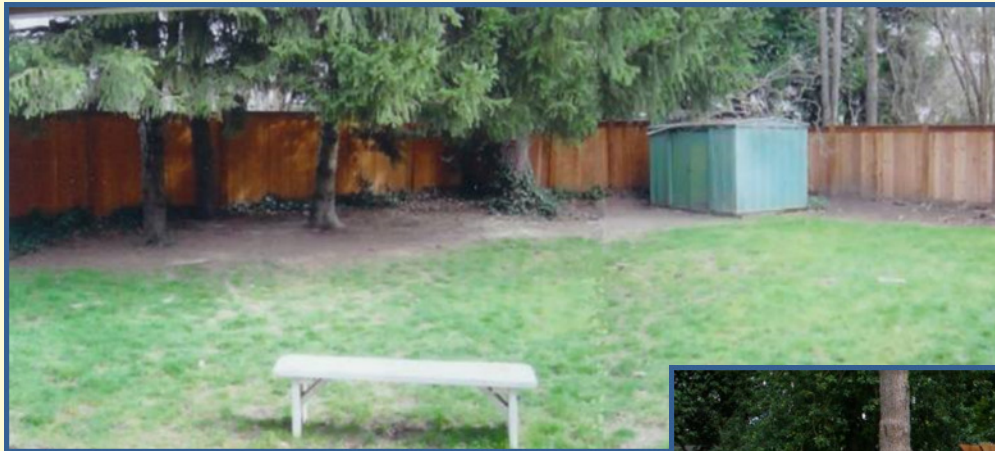

After:

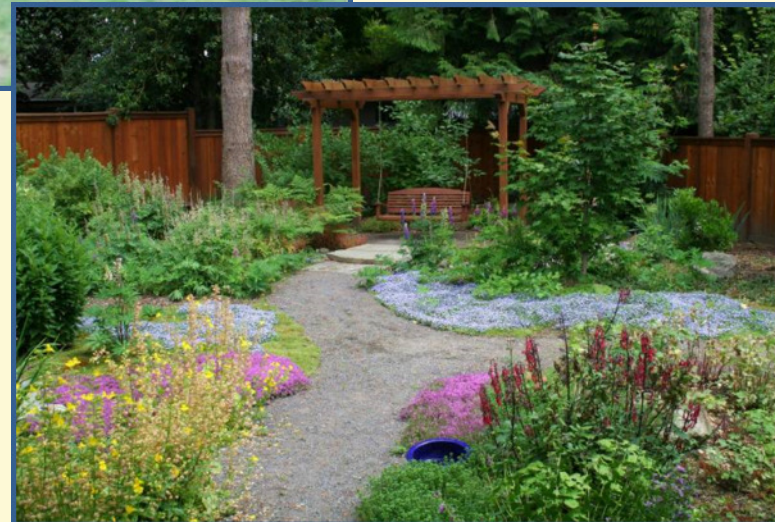

Planning Your Landscape

Key to Success

HOA, Codes, Restrictions???

Site Analysis

Determine Needs

Design Concept and Considerations

Prepare the Site



Planning Your Landscape

- Plan first
 - Analyze your site
 - Determine needs
 - Design considerations
 - Site preparation
- Purchase
- Plant Last
- Florida-Friendly Principles in Practice



Key to Success

Proper planning and plant selection

- Avoids problems later
- Saves energy, money, water, effort, etc.
- Makes the landscape more enjoyable
- Ensures needs are met



Key to Success

Plan First, Plant Once

- This is a process, not a one-time event!
- Know the plants and the conditions required to thrive
- Consult with your UF/IFAS County Extension Office
- View edis.ifas.ufl.edu or UF Whatver!
- Utilize regional gardening books and magazines



Site Analysis

What do you have and how can you use it?

- Light
- Soil type
 - Sand, clay, silt
 - Soil pH
 - Soil moisture
- Soil pH
 - Minimal cost



Clay



Sand

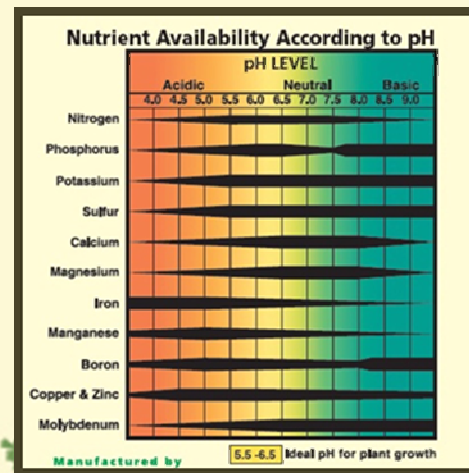

Standing water

Site Analysis

What do you have and how can you use it?

- Views
- Hardscape
- Structural limitations and obstructions



thetreecenter.com



Sun or shade?

Site Analysis

Climatic Conditions

- Consider the orientation of your home
- Locate microclimates in your landscape
- Use The FFL Guide to Plant Selection & Landscape Design to guide plant choices
- Choose plants recommended for your zone, which is????



Determine Needs and Wants

How Do You Currently Use the Property?

- Family activities
- Pets
- Storage
- Vegetable garden
- Outdoor entertainment



Design Considerations

Level of Maintenance



Design Considerations

Level of Maintenance



Design Considerations

Eventual Size and Other Factors

- Mature height and spread
- Growth rate
- Shape
- Salt tolerance
- Native or non-native
adaptive
- Susceptibility to pests/disease



Landscape Plan

- Arrange activity areas
- Draw where you want trees, shrubs, ground covers, or flowering plants
- Group plants according to needs

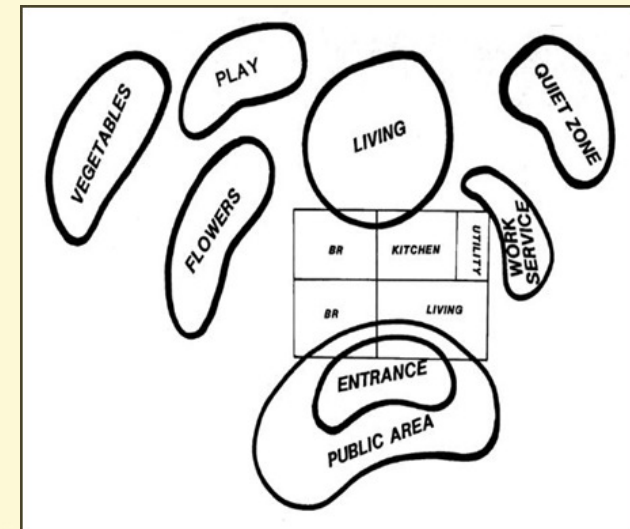
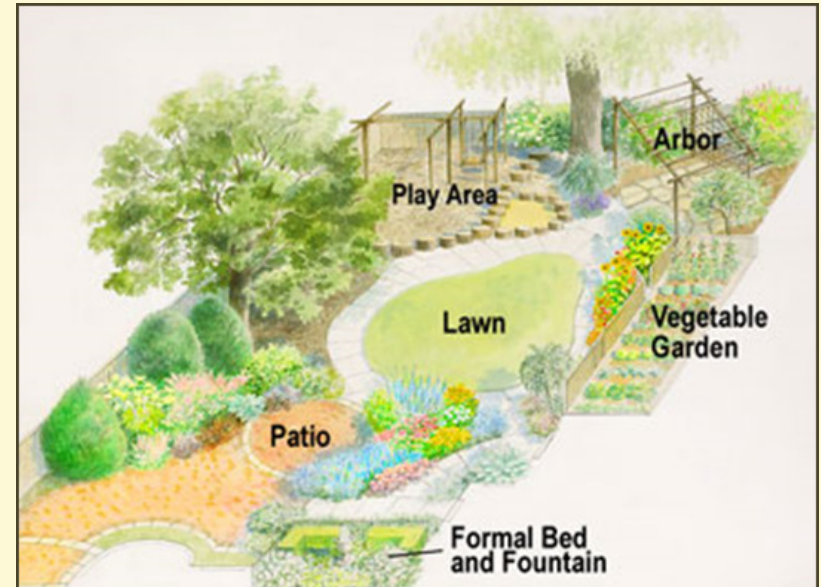

Site Preparation

- Remove unwanted plants and debris
- Fix grade
- Amend the soil



Buying Healthy Plants

- Look for new growth
- Roots should be white and fibrous
- Avoid pot bound plants
- Avoid diseased or insect infested plants



Comparing Landscapes

Landscape 1

- Quarter acre
- Entire $\frac{1}{4}$ acre covered in lawn (10,890 sq. ft.)



Landscape 2

- Quarter acre
- $\frac{1}{16}$ covered in lawn (2723 sq. ft.)
- Rest of the area is lower-maintenance plants

Landscape 1 has four times the energy costs as Landscape 2!
(Parker 1982)

Environmentally Friendly Landscaping



Your yard is an integral part of the protection and preservation of Florida's environment



Conclusions

The decisions we make about our landscapes have a profound impact on water quality.

With a little thought, our landscapes can combine beauty, function, and environmental protection.

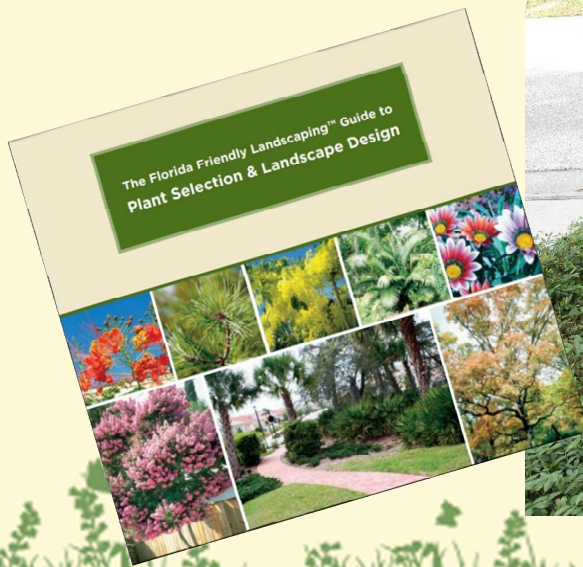

Show Off Your Landscape!

Community Water Wise Award Program

Sponsored by Tampa Bay Water

&

Florida-Friendly Landscaping™ Yard Recognition



Thank you!

Protect water quality, conserve water and save money

Reduce, reuse, recycle and repeat!



Presentation revised by Lynn Barber, FFL Agent
UF/IFAS Extension Hillsborough County

labarber@ufl.edu; barberL@hillsboroughcounty.org

813-744-5519 x 54105

